

MERCEDES® IR TOOL

Infrared Mercedes-Benz®
key programming system



**INTEGRATED
SYSTEM**



**USER-FRIENDLY
INTERFACE**

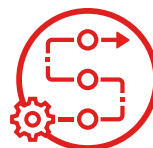

**GUIDED
PROCEDURE**

 **KEYLINE**

A BIANCHI I770 GROUP COMPANY

MERCEDES® IR TOOL

The solution for Mercedes-Benz®
infrared remote controls

POWERFUL, FUNCTIONAL AND EASY TO USE

Mercedes® IR Tool allows the programming of the infrared slot remote controls of Mercedes-Benz® cars, using the potential of the Keyline **STAK KCT®** app, one of the simplest and most immediate stand-alone tools on the market.

*Available from version 2.1.0.0

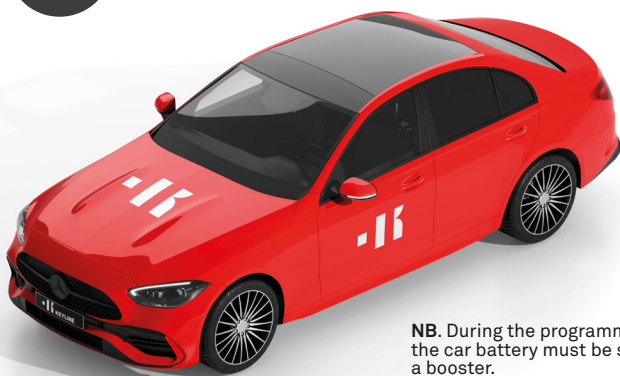
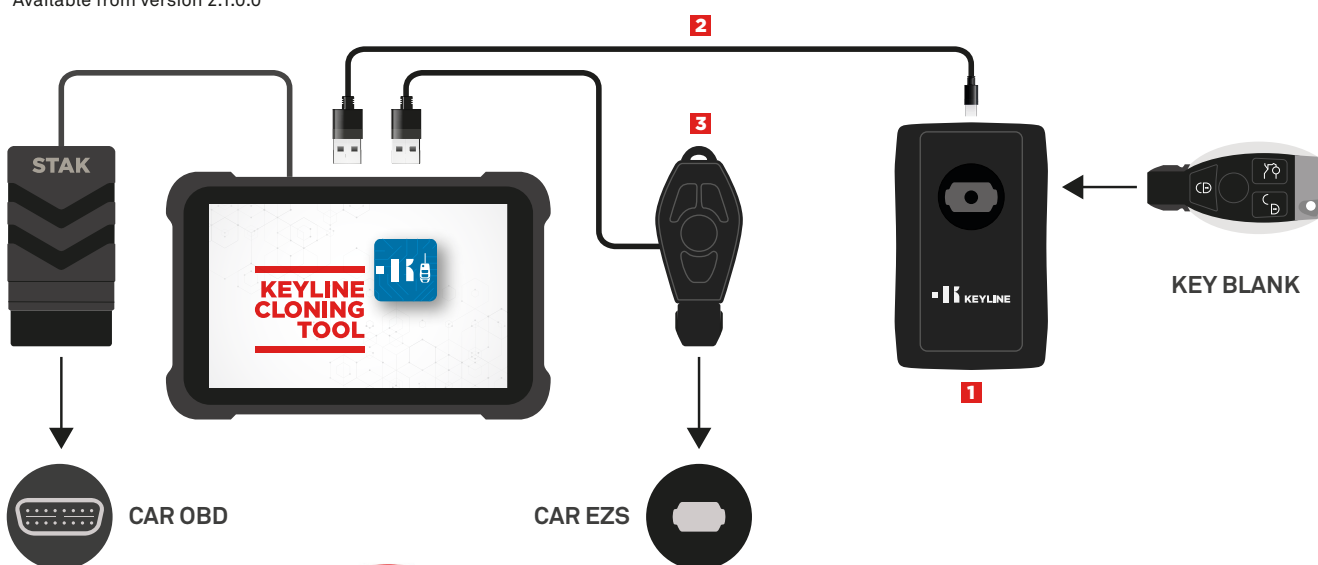

NB. During the programming operations the car battery must be supported by a booster.

When inserted into the car's ignition, the **IR Emulator** simulates the original remote control to read the data from the control unit.

The **IR Reader** has an infrared slot for reading and writing the remote control.

The W204 and W639 series need the Keyline adapter cable for Renault® BI803 - OPZ11589B

Automotive Programming Kit

The system completes the functions of the Keyline Automotive Programming Kit.

All Key Lost

The system works when all keys have been lost or are not functioning, there's **no need for an original key**.

All brands and trademarks published here are registered trademarks and the exclusive property of their respective automotive companies or group.

Copyright Keyline © 2023



Keyline S.p.A.

Via Camillo Bianchi, 2
31015 Conegliano (TV) Italy

T +39 0438 202 511

info@keyline.it
www.keyline.it

Discover the sales network
of Keyline products.



PROMO23-035 05/23